

# Project – A Vision For Blacon

As part of its transformation from a community partnership to a development trust, Blacon Community Trust, the partnership needed a clear vision, and the identification of robust actions to help direct and deliver future regeneration.

### Key Actions

As part of a specialist team, Pulse developed a comprehensive Vision and Action Plan, which addressed the physical and economic issues that were preventing growth and which set out a spatial framework for change. In particular this included development of a ‘Social Enterprise and Community Use’ Strategy, focusing on the potential to develop new social enterprise activity and identifying the key issues and opportunities.

### Achievements

- Fuller understanding of what could be achieved in the area to benefit the community
- Identified specific opportunities for creating local facilities, for example, workspace provision, community café, and a media service
- Development of an action plan of projects, highlighting potential funding, timescales and partners
- Blacon Community Trust has since developed a successful social enterprise incubator workspace programme

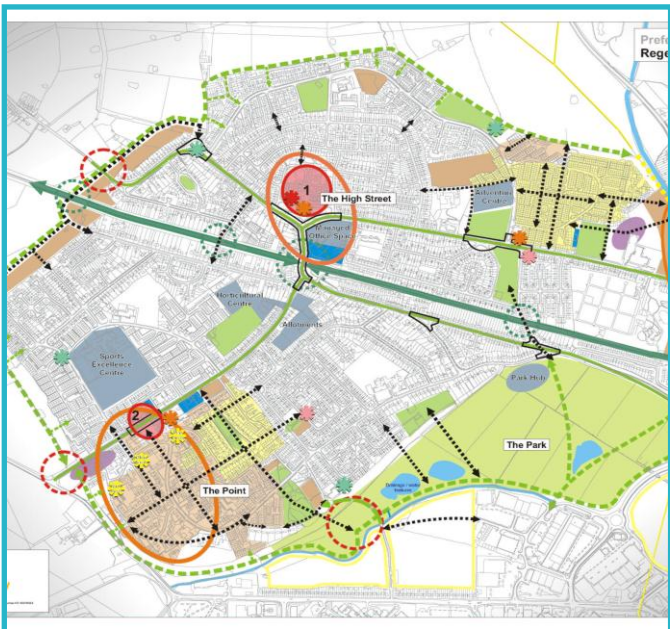

***“Vision and Action Planning process has ensured that the local community will benefit directly from the regeneration work that will now take place in the area, especially in terms of employment opportunities and opportunities to set up local businesses.”***

**David McGuire,**  
Blacon Community Trust